

WN 056096 45532  
01 04/07

Regelmäßig fetten  
mit DORMA Fett für Wartung  
Best. Nr.: 35500000001

Lubricate with greas at regular intervals  
with DORMA greas for service  
Order No.: 35500000001

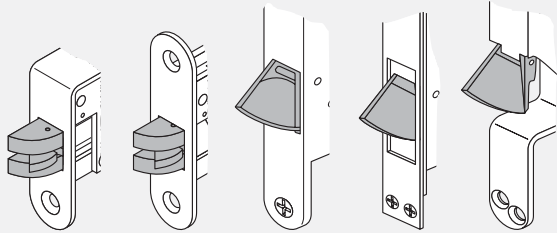

**HZ 17**

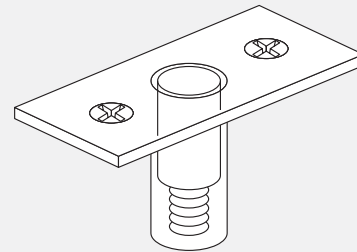

**HZ 26**

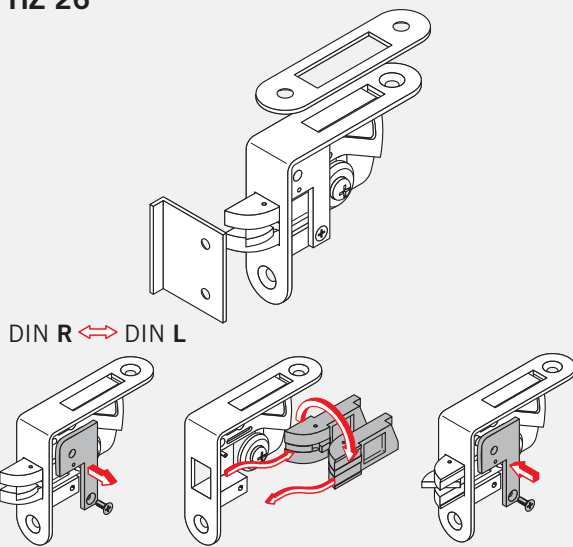

**HZ 27**

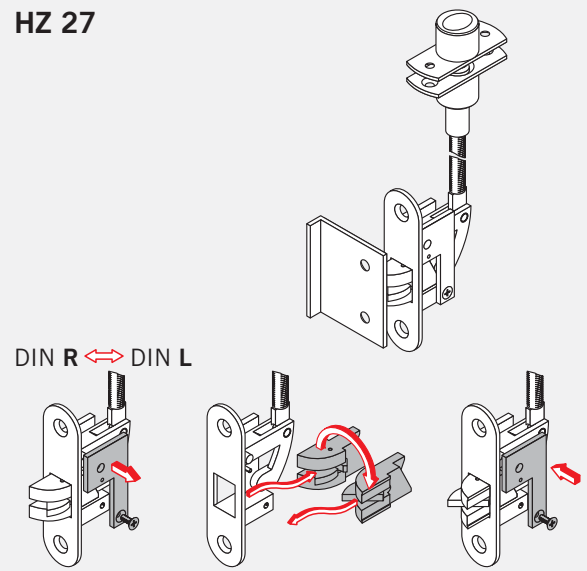

**HZ 31**

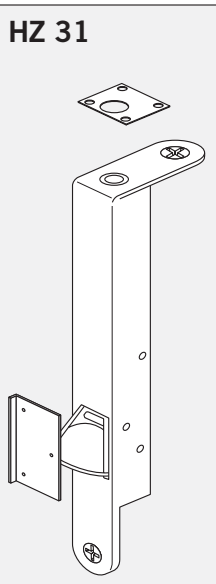

**HZ 33F**

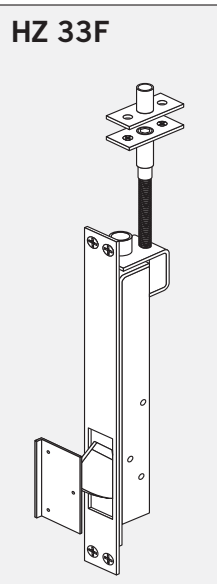

**HZ 34**

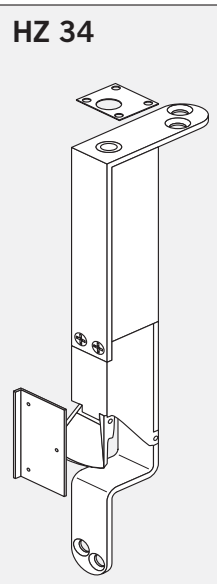

**HZ 43-20**

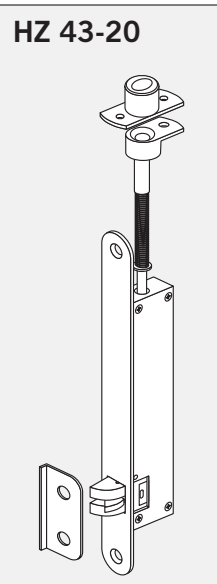

**HZ 43-32**

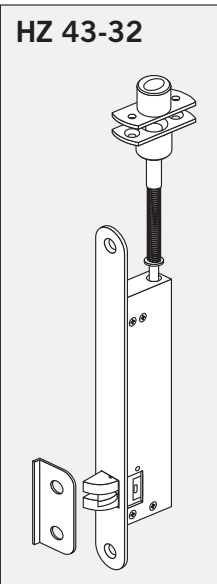

WN 056096 45532  
02\_04/07

## HZ 17

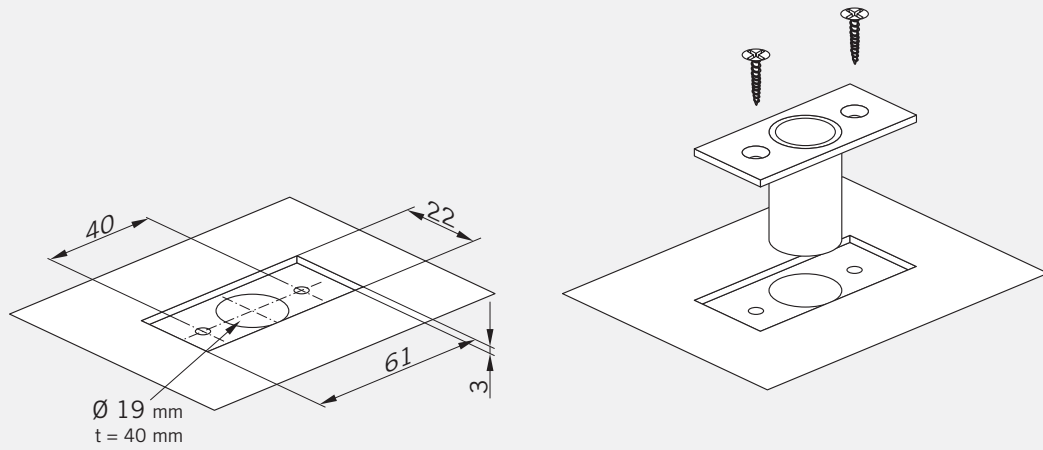

Nach dem Bohren das Loch von Schmutz befreien.  
Clean the hole after drilling.

## HZ 26

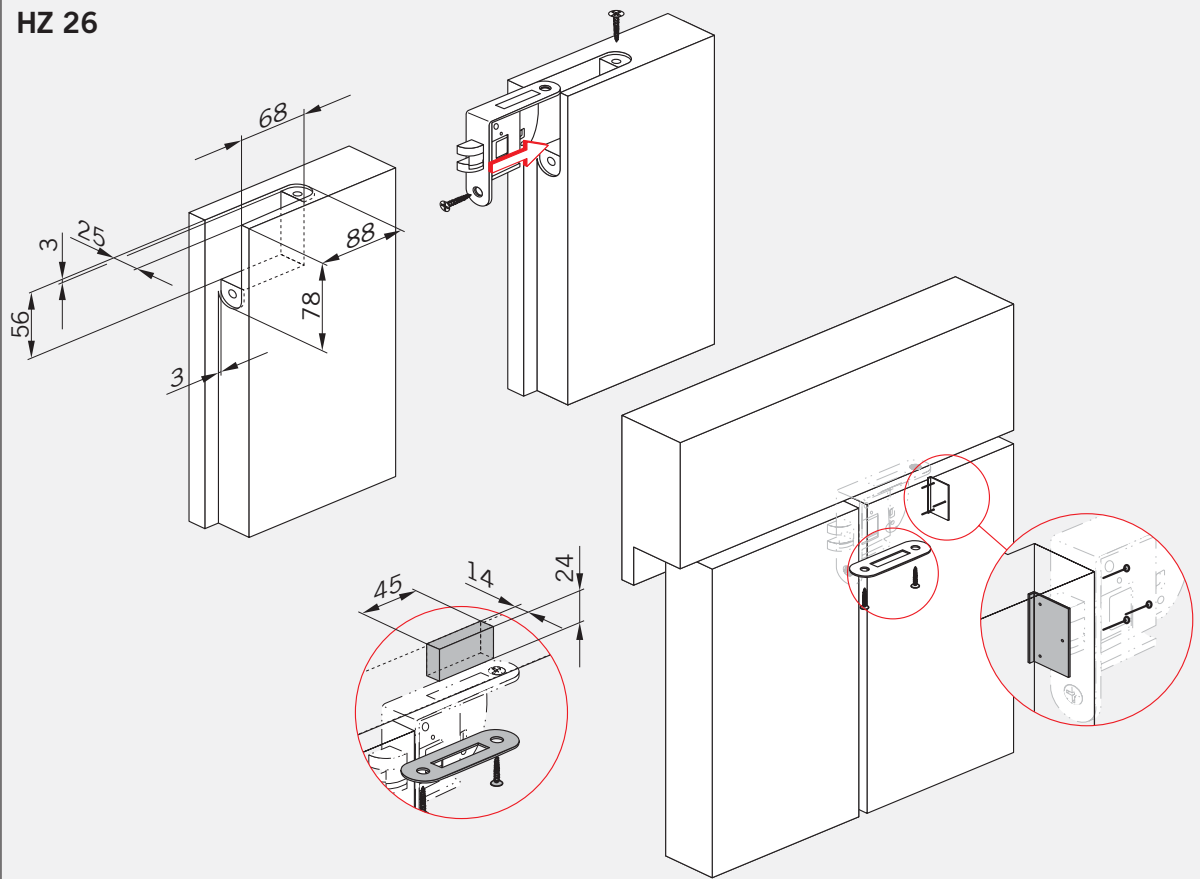

WN 056096 45532  
03 04/07

**HZ 27**

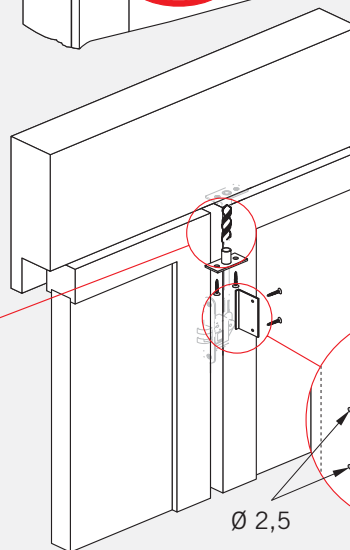
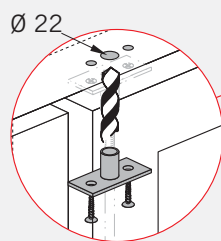
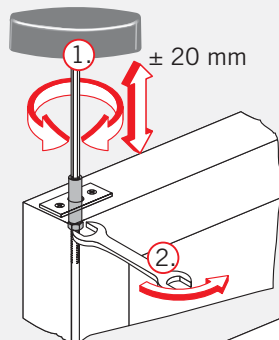
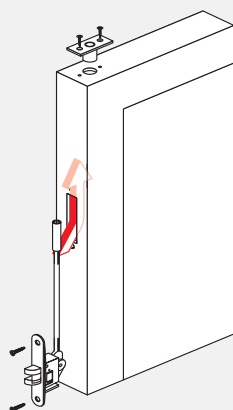
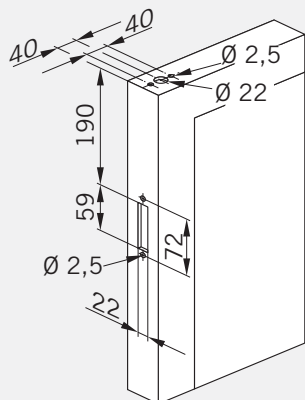

**HZ 31**

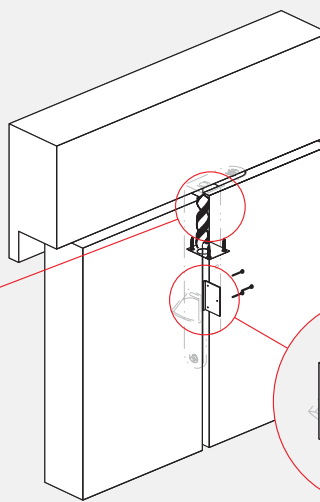
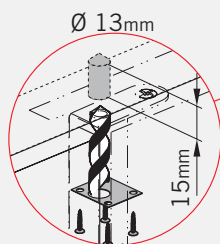
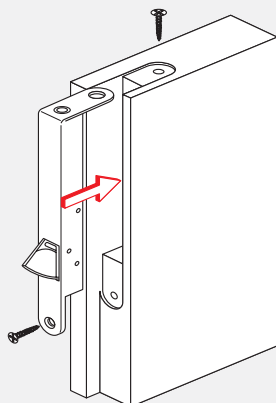
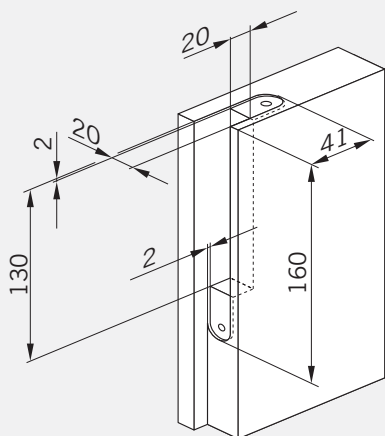

WN 056096 45532  
04 04/07

HZ 33F

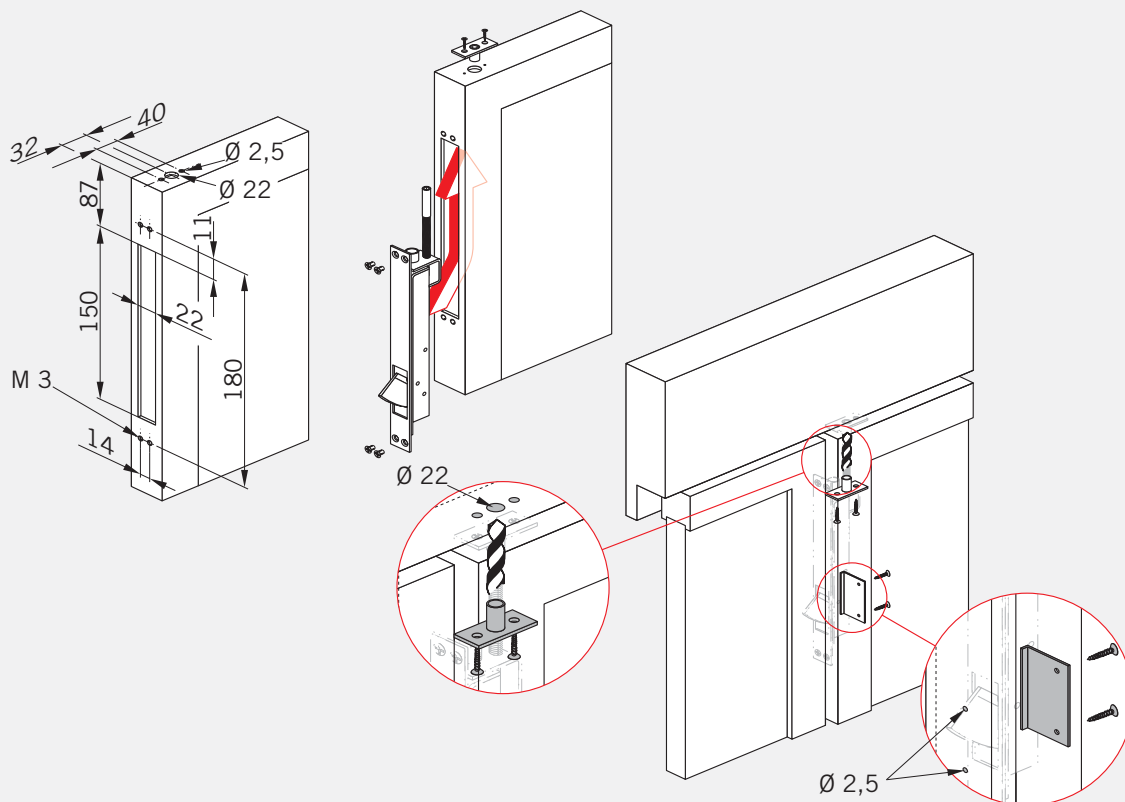

HZ 34

